

pressure gauges with electric contacts all stainless steel construction DS 6" (150mm)



Compliance to requirements of
LVD 2014/35/EU - PED 2014/68/EU



These instruments are manufactured in accordance with the safety standards UNI 8541, DIN 16006, and ANSI B40.1. They are used to control the electrical operation of compressors, pumps, presses, hydraulic and pneumatic equipment, as well as in chemical and petrochemical plants. In the event of leaks or damage to the sensing element, the operator is protected by a solid baffle wall on the front of the instrument and a blow-out back on the rear. The contacts, adjustable across the entire range, open or close the circuit depending on the position of the pointer. For use in severe operating conditions, such as rapid and frequent pressure changes, vibrations, and pulsations, the instruments can be liquid-filled. The damping liquid significantly reduces the effects of these factors, as well as those caused by corrosive atmospheres, improving both the performance and the lifespan of the pressure gauge and electrical contacts. Additionally, versions with intrinsically safe inductive contacts are available.

1.M3.1 - Standard Model

Ranges: from 0...15 to 0...20000 psi (from 0...1 to 0...1600 bar or equivalent units).

Mechanical contact: sliding contact, magnetic snap-action, electronic, inductive.

Accuracy: $\pm 1,0$ % as per EN 837-1 - DIN 16085 (1).

Ambient temperature: -13...+149 °F (-25...+65 °C).

Process fluid temperature: max +212 °F (+100 °C).

Working pressure: max 75% of the full scale value.

Over pressure: not suitable.

Protection: IP 55 as per EN 60529/IEC 529.

Socket material: AISI 316L st.st.

Elastic element: AISI 316L st.st.

Case: stainless steel.

Ring and blow out disk: stainless steel.

Window: plastic.

Movement: stainless steel.

Dial: aluminium, white with black markings.

Pointer: not adjustable, aluminium, black.

1.M3.3 - Filled Model, Lower connection only

Mechanical contact: magnetic snap-action.

Accuracy: $\pm 1,6$ % as per EN 837-1 - DIN 16085 (1).

Process fluid temperature: max +149 °F (+65 °C).

Protection: IP 65 as per EN 60529/IEC 529.

Filling liquids: silicone dielectric oil.

Other features: as Standard Model.

(1) The interference of the contacts affects the accuracy: when the instrument's pointer is influenced by the action of the contact arm, add 50% of the instrument's accuracy (excluding the intervention zone between ± 5 % if the electrical contact is of the magnetic snap type).

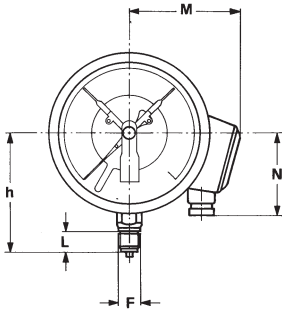
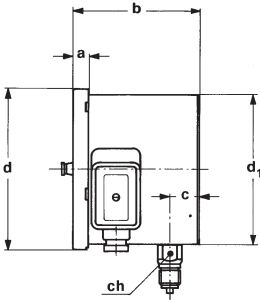

A - LOWER CONNECTION

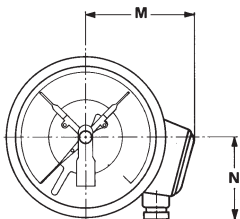
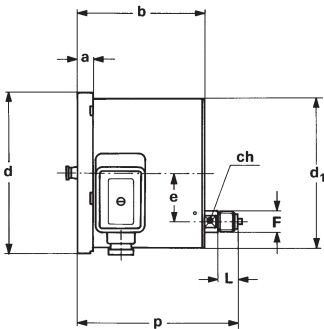

D - BACK CONNECTION

Mounting	F	a	b	c	d	d ₁	e	h	p	M	N	L	ch	Weight (1)
Lower	41M G 1/2 A	0.59" (15)	5" (127)	1.18" (30)	6.34" (161)	5.89" (149,5)		4.65" (118)		4.33" (110)	3.27" (83)	0.78" (20)	0.94" (24)	3.19 lbs (1,45 kg)
Back							1.88" (47,8)		6,30" (160)				0.67" (17)	3.08 lbs (1,4 kg)

dimensions : inches (mm)

(1) when filled, add 3.63 lbs (1,65 kg)

CONTACT TYPE (1)

MODEL	Standard		Filled	
Contact type	Sliding contact		Magnetic snap-action contact	
Contact number	1	2	1	2
Junction box	4 poles + GND	4 poles + GND	4 poles + GND	4 poles + GND
ø exit cables: inches (mm)	0,35...0,55 (9...14)	0,35...0,55 (9...14)	0,35...0,55 (9...14)	0,35...0,55 (9...14)
Minimum range	15 psi (1bar)	23 psi (1,6 bar)	23 psi (1,6 bar)	36 psi (2,5 bar)

(1) Functional characteristics, electric diagrams and contact types are available on data-sheets :

“ELECTRIC CONTACTS”.

OPTIONS

C -	Back flange, for lower connection pressure gauges
P02 -	Oxygen service
E65 -	Protection IP 65 as per IEC 529, for standard model

“HOW TO ORDER” SEQUENCE

Section / Model /Case / Mounting / Diameter / Range / Process connection / Electric contact / Options

1 M3 1 A G 41M 01S...M9D C
3 D P02, E65

